

FaceDeep 3 IRT

Smart Face Recognition Terminal with
Body Temperature Detection



Infrared Thermal
Temperature
Detection



Wi-Fi



4G



Mask
Detection



Cloud



- FaceDeep 3 IRT with Body Temperature Detection technology, specifically designed for simultaneous personnel access authority.
- New ideal touchless solution for the people to access control on the entrance or record time attendance and simultaneously check temperature and mask-wearing without having to touch a terminal or gate.
- Equipped with a 5" IPS touch screen.
- Register up to 10,000 users for dynamic face authentication.
- Optional battery backup, specifically designed to work consistently in unstable power supply environments, such as Construction sites, Manufacturing, Schools and buildings in countryside, etc.

FaceDeep 3 IRT

Smart Face Recognition Terminal with Body Temperature Detection

FaceDeep 3 IRT



Product				
Model		FaceDeep 3 IRT	FaceDeep 3 Pro IRT	FaceDeep 3 4GIRT
General	Identification mode	Face, Card, ID+Password		
	Face Recognition Distance	0.5 ~ 1.5m (19.69 ~ 59.06")		
	Face Recognition Speed	<0.3 S		
	RFID Technology	125KHz EM	13.56MHz Mifare	13.56MHz Mifare
IRT (Palm Temperature Detection)	Detection Distance	10~20mm(0.39~0.79")		
	Temperature Range	23°C~46°C (73°F~114°F)		
	Temperature Accuracy*	±0.3°C (0.54°F)		
Capacity	Max Users	6,000	10,000	10,000
	Max Cards	6,000	10,000	10,000
	Max Logs	100,000		
Function	Time Attendance Mode	8		
	Group, Time Zone	16 Access Groups, 32 TimeZone		
	WebServer	√		
	Record Auto Inquiry	√		
	Voice Prompt	√		
	Clock Bell	√		
	Multiple Language	√		
Hardware	CPU	Dual 1.0GHz		
	Camera	Dual Camera(VIS & NIR)		
	Scanning Area	Horizontal : ±20° Vertical : ±20°		
	Display	5" TFT touch Screen Resolution 720*1280		
	Smart LED	Support		
	Dimensions(W x H x D)	146*165*34 mm(5.75*6.50*1.34")		
	Working Temperature	-5°C~60°C (23°F~160°F)		
	Humidity	0% to 95%		
Interface	Power Input	DC 12V 2A		
	TCP/IP	√		
	RS485	√		
	USB PEN	√		
	Wi-Fi	√	-	-
	Wi-Fi+Bluetooth	-	√	-
	4G	-	-	√
	Relay	1 Relay Out		
	Temper Alarm	√		
	Wiegand	1 In & 1 Out		
Software Ompatibility	Door Contact	√		
	CrossChex Standard	√		
	CrossChex Cloud	√		

FaceDeep 3 IRT

Smart Face Recognition Terminal with Body Temperature Detection

System Configurations

Local Deployment (Crosschex Standard)

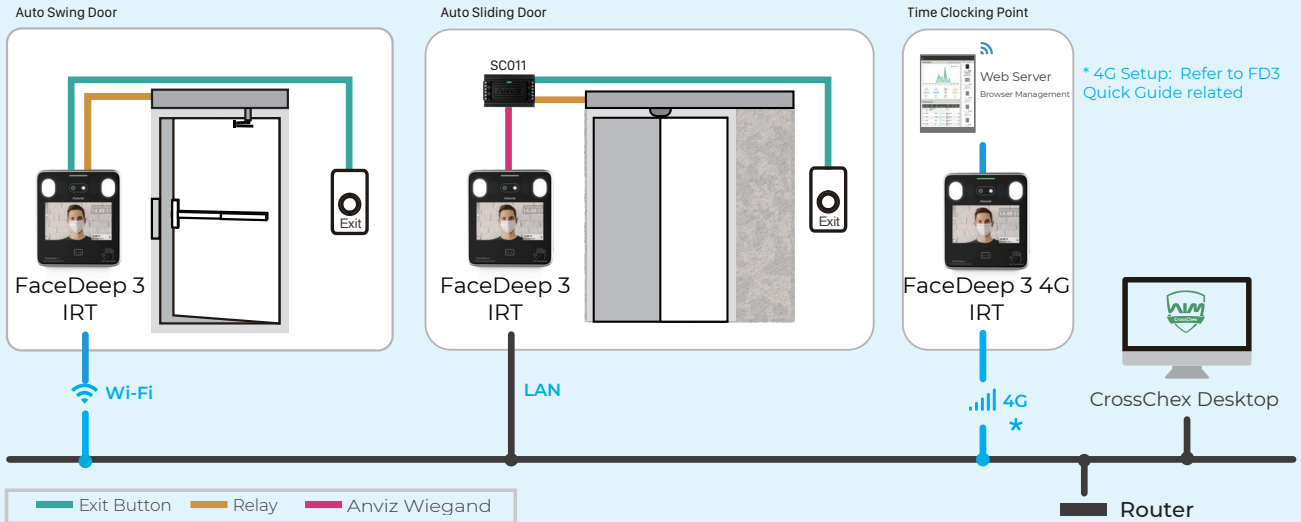

Cloud Deployment (Crosschex Cloud)

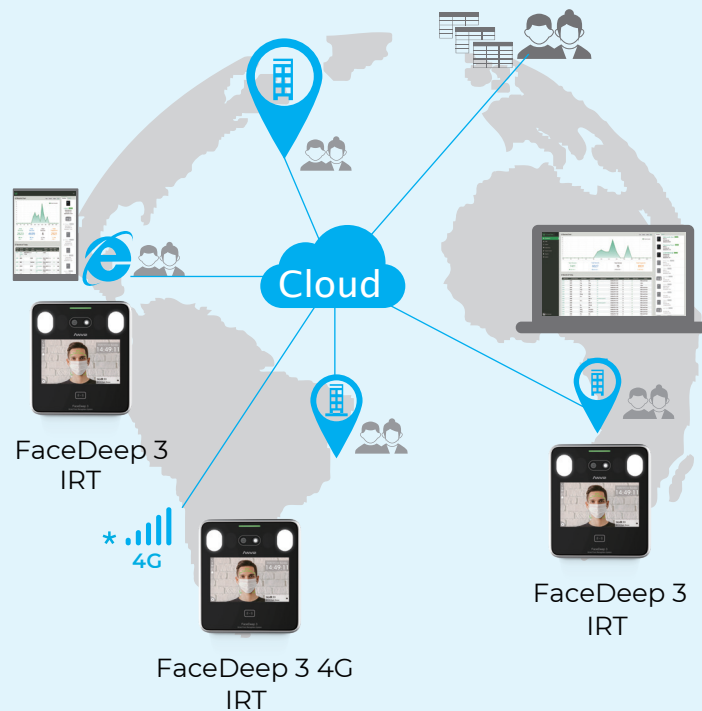

* 4G Setup: Refer to FD3 Quick Guide Related

*Disclaimer: Anviz's products listed herein are not designed for medical devices and not intended for use in the diagnosis of disease or other conditions. When configured correctly, Anviz's products listed herein can identify individuals with skin-surface temperature relative to a preset figure but should not be solely or primarily relied upon to diagnose any other disease. Anviz's products must be used in accordance with local laws and regulations.